



Heyco® Rubber Grommets

For Panels .063" (1,6 mm) Thick

- **Used to protect through holes.** Help eliminate sharp edges so your wires are protected and add aesthetic value to your application.
- 115 sizes available that will accommodate mounting holes ranging from .250" (6,4 mm) to holes as large as 2.375" (60,3 mm) diameter and panel thicknesses from .063" (1,6 mm) to .188" (4,8 mm).
- Rubber grommets are constructed of SBR (unless otherwise noted) with an operating temperature range of -40°F (-40°C) to 221°F (105°C).
- SBR grommets have good water resistant characteristics and are suitable for most moderate chemicals and wet or dry organic acids.
- Provide vibration dampening.

MOUNTING HOLE DIAMETER	PART NO.	DESCRIPTION	MATERIAL	PART DIMENSIONS					
				A Inside Diameter		B Head Diameter		C Overall Height	
in. mm.	Black			in. mm.	in. mm.	in. mm.	in. mm.	in. mm.	

For .063" (1,6 mm) Thick Panels

.250	6,4	G1004	RG 250-4-2	SBR	.13	3,2	.34	8,7	.19	4,8
		G1005	RG 250-5-2	SBR	.16	4,0	.38	9,5		
		G1006	RG 250-5-2A	SBR	.16	4,0	.44	11,1	.38	9,5
.312	7,9	G1017	RG 312-6-2	SBR	.19	4,8	.41	10,3	.22	5,6
		G1018	RG 312-6-2A	Nitrile	.19	4,8	.44	11,1	.19	4,8
		G1019	RG 312-6-2B	SBR	.19	4,8	.50	12,7	.25	6,4
		G1026	RG 312-7-2	SBR	.22	5,6	.44	11,1	.19	4,8
.375	9,5	G1037	RG 375-8-2	EPDM	.25	6,4	.56	14,3	.25	6,4
		G1042	RG 375-9-2	SBR	.28	7,1				
.437	11,1	G1052	RG 437-8-2	SBR	.25	6,4	.63	15,9	.19	4,8
		G1053	RG 437-8-2A	Isoprene	.25	6,4	.63	15,9	.31	8,0
		G1061	RG 437-10-2	SBR	.31	8,0	.63	15,9	.28	7,1
.500	12,7	G1089	RG 500-12-2	SBR	.38	9,5	.63	15,9	.25	6,4
		G1090	RG 500-12-2A	SBR	.38	9,5	.69	17,5	.28	7,1
.562	14,3	G1112	RG 562-10-2	SBR	.31	8,0	.81	20,7	.31	8,0
		G1123	RG 562-14-2	SBR	.44	11,1	.75	19,1	.25	6,4
.625	15,9	G1130	RG 625-12-2	SBR	.38	9,5	.88	22,2	.31	8,0
		G1137	RG 625-16-2	SBR	.50	12,7	.81	20,7	.28	7,1
.687	17,5	G1150	RG 687-14-2	SBR	.44	11,1	.94	23,8	.31	8,0
		G1151	RG 687-14-2A	SBR	.44	11,1	.94	23,8	.35	8,8
		G1155	RG 687-16-2	SBR	.50	12,7	.88	22,2	.25	6,4
.750	19,1	G1174	RG 750-12-2	SBR	.38	9,5	1.00	25,4	.38	9,5
		G1176	RG 750-16-2	SBR	.50	12,7	.88	22,2		
		G1177	RG 750-16-2A	SBR	.50	12,7	1.00	25,4	.25	6,4
.812	20,6	G1192	RG 812-16-2	SBR	.50	12,7				
		G1197	RG 812-18-2	SBR	.56	14,3	1.06	27,0	.31	8,0
.875	22,2	G1208	RG 875-10-2	SBR	.31	8,0	1.38	34,9	.25	6,4
		G1215	RG 875-20-2	SBR	.63	15,9	1.13	28,6	.31	8,0
1.000	25,4	G1242	RG 1000-12-2	SBR	.38	9,5	1.25	31,8	.25	6,4
		G1246	RG 1000-16-2	SBR	.50	12,7				
		G1252	RG 1000-22-2	SBR	.69	17,5	1.31	33,4	.38	9,5
1.062	27,0	G1258	RG 1000-24-2	SBR	.75	19,1	1.25	31,8	.30	7,5
		G1269	RG 1062-24-2	SBR	.75	19,1	1.38	34,9	.38	9,5
1.250	31,8	G1290	RG 1250-16-2	SBR	.50	12,7				
		G1294	RG 1250-20-2	SBR	.63	15,9	1.50	38,1	.25	6,4
		G1298	RG 1250-24-2	SBR	.75	19,1	1.63	41,3		
		G1303	RG 1250-28-2	SBR	.88	22,2	1.63	41,3	.44	11,1
1.375	34,9	G1311	RG 1250-32-2	SBR	1.00	25,4	1.56	39,7	.31	8,0
		G1320	RG 1375-32-2	SBR	1.00	25,4	1.75	44,5	.44	11,1
1.500	38,1	G1347	RG 1500-36-2	SBR	1.13	28,6	1.88	47,6	.38	9,5
		G1349	RG 1500-40-2	Nitrile	1.25	31,8	1.88	47,6	.34	8,7

Standard color black.



Quick Specs

Material
Temperature Range

SBR, Nitrile, EPDM, or Isoprene
-40°F (-40°C) to 221°F (105°C)

“Stay Connected” with



Bushings, Grommets, HEYcaps & Plugs

a PennEngineering® Company



Heyco® Rubber Grommets

For Panels from .063" (1,6 mm) to .125" (3,2 mm) Thick

MOUNTING HOLE DIAMETER		PART NO.	DESCRIPTION	MATERIAL	PART DIMENSIONS					
in.	mm.				A Inside Diameter		B Head Diameter		C Overall Height	
		Black			in.	mm.	in.	mm.	in.	mm.
For .063" (1,6 mm) Thick Panels (continued)										
1.750	44,5	G1369	RG 1750-48-2	SBR	1.50	38,1	2.13	54,0	.44	11,1
2.375	60,3	G1409	RG 2.375-40-2	Nitrile	1.25	31,8	2.75	69,9		
2.500	63,5	G1418	RG 2.5-40-2	Nitrile	1.25	31,8	2.88	73,0		
		G1422	RG 2.5-68-2	SBR	2.13	54,0				
For .078" (2,0 mm) Thick Panels										
1.000	25,4	G1253	RG 1000-22-3	SBR	.69	17,5	1.31	33,4	.38	9,5
For .094" (2,4 mm) Thick Panels										
.281	7,1	G1010	RG 281-6-3	SBR	.19	4,8	.44	11,1	.22	5,6
.312	7,9	G1014	RG 312-6-3	SBR	.19	4,8	.50	12,7	.28	7,1
.375	9,5	G1033	RG 375-4-3	SBR	.13	3,2	.50	12,7	.31	8,0
		G1038	RG 375-8-3	SBR	.25	6,4	.50	12,7	.25	6,4
		G1039	RG 375-8-3A	SBR	.25	6,4	.56	14,3	.28	7,1
.437	11,1	G1062	RG 437-10-3	Nitrile	.31	8,0	.63	15,9	.31	8,0
.750	19,1	G1178	RG 750-16-3	SBR	.50	12,7	.88	22,2	.34	8,7
		G1179	RG 750-16-3A	SBR	.50	12,7	.97	24,6	.28	7,1
1.125	28,6	G1281	RG 1125-28-3	SBR	.88	22,2	1.50	38,1	.34	8,7
2.000	50,8	G1387	RG 2000-48-3	SBR	1.50	38,1	2.38	60,3	.38	9,5
For .110" (2,8 mm) Thick Panels										
.630	16,0	G1140	RG 630-16-3	SBR	.50	12,7	.81	20,6	.30	7,6
For .125" (3,2 mm) Thick Panels										
.312	7,9	G1020	RG 312-6-4	SBR	.19	4,8	.44	11,8	.25	6,4
.406	10,3	G1047	RG 406-9-4	SBR	.28	7,1	.63	15,9	.38	9,5
.437	11,1	G1056	RG 437-8-4	SBR	.25	6,4	.63	15,9	.25	6,4
.500	12,7	G1091	RG 500-9-4	SBR	.28	7,1	.75	18,9	.38	9,7
		G1092	RG 500-12-4	SBR	.38	9,5	.63	15,9	.31	8,0
		G1093	RG 500-12-4A	SBR	.38	9,5	.63	15,9	.41	10,3
.562	14,3	G1114	RG 562-10-4	SBR	.31	8,0	.81	20,7	.38	9,5
.625	15,9	G1127	RG 625-6-4	Nitrile	.19	4,8	.88	22,2	.25	6,4
		G1132	RG 625-12-4	SBR	.38	9,5	.88	22,2	.38	9,5
.687	17,5	G1152	RG 687-14-4	SBR	.44	11,1	.94	23,8	.38	9,5
.812	20,6	G1188	RG 812-12-4	SBR	.38	9,5	1.06	27,0		
		G1193	RG 812-16-4	SBR	.50	12,7	1.06	27,0		
		G1198	RG 812-18-4	SBR	.56	14,3	1.06	27,0		
.875	22,2	G1218	RG 875-20-4	SBR	.63	15,9	1.13	28,6	.31	8,0
1.000	25,4	G1244	RG 1000-12-4	SBR	.38	9,5	1.25	31,8		
		G1247	RG 1000-16-4	SBR	.50	12,7	1.25	31,8		
		G1255	RG 1000-22-4	SBR	.69	17,5	1.31	33,4		
1.250	31,8	G1259	RG 1000-24-4	EPDM	.75	19,1	1.19	30,2		
		G1260	RG 1000-24-4A	SBR	.75	19,1	1.25	31,8		
1.250	31,8	G1291	RG 1250-16-4	SBR	.50	12,7	1.50	38,1	.31	8,0
		G1299	RG 1250-24-4	SBR	.75	19,1	1.63	41,3		
		G1304	RG 1250-28-4	SBR	.88	22,2	1.63	41,3		

Standard color black.

- **Used to protect through holes.** Help eliminate sharp edges so your wires are protected and add aesthetic value to your application.
- 115 sizes available that will accommodate mounting holes ranging from .250" (6,4 mm) to holes as large as 2.375" (60,3 mm) diameter and panel thicknesses from .063" (1,6 mm) to .188" (4,8 mm).
- Rubber grommets are constructed of SBR (unless otherwise noted) with an operating temperature range of -40°F (-40°C) to 221°F (105°C).
- SBR grommets have good water resistant characteristics and are suitable for most moderate chemicals and wet or dry organic acids.
- Provide vibration dampening.

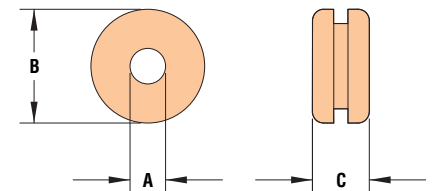

Material	SBR, Nitrile or EPDM
Temperature Range	-40°F (-40°C) to 221°F (105°C)

Quick Specs



Heyco® Rubber Grommets

For Panels .125" (3,2 mm) to .188" (4,8 mm) Thick

- **Used to protect through holes.** Help eliminate sharp edges so your wires are protected and add aesthetic value to your application.
- 115 sizes available that will accommodate mounting holes ranging from .250" (6,4 mm) to holes as large as 2.375" (60,3 mm) diameter and panel thicknesses from .063" (1,6 mm) to .188" (4,8 mm).
- Rubber grommets are constructed of SBR (unless otherwise noted) with an operating temperature range of -40°F (-40°C) to 221°F (105°C).
- SBR grommets have good water resistant characteristics and are suitable for most moderate chemicals and wet or dry organic acids.
- Provide vibration dampening.

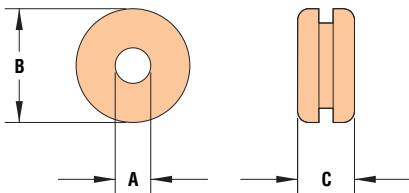

MOUNTING HOLE DIAMETER		PART NO. Black	DESCRIPTION	MATERIAL	PART DIMENSIONS					
in.	mm.				A Inside Diameter		B Head Diameter		C Overall Height	
					in.	mm.	in.	mm.	in.	mm.

For .125" (3,2 mm) Thick Panels (continued)

1.375	34,9	G1322	RG 1375-32-4	SBR	1.00	25,4	1.75	44,5	.50	12,7
1.500	38,1	G1350	RG 1500-40-4	SBR	1.25	31,8	1.88	47,6	.41	10,3
1.625	41,3	G1363	RG 1625-42-4	SBR	1.31	33,4	2.00	50,8	.44	11,1
		G1364	RG 1625-44-4	SBR	1.38	34,9	1.88	47,6	.41	10,3
1.750	44,5	G1371	RG 1750-48-4	SBR	1.50	38,1	2.13	54,0	.50	12,7
2.000	50,8	G1392	RG 2000-56-4	SBR	1.75	44,5	2.38	60,3	.38	9,5
2.500	63,5	G1423	RG 2.5-68-4	SBR	2.13	54,0	2.88	73,0	.44	11,1

For .156" (4,0 mm) Thick Panels

.500	12,7	G1094	RG 500-12-5	SBR	.38	9,5	.69	17,5	.31	8,0
.750	19,1	G1181	RG 750-16-5	SBR	.50	12,7	.94	23,8	.41	10,3
1.500	38,1	G1348	RG 1500-38-5	SBR	1.19	30,2	1.75	44,5		

For .188" (4,8 mm) Thick Panels

.312	7,9	G1022	RG 312-6-6	SBR	.19	4,8	.44	11,8	.31	8,0
.375	9,5	G1034	RG 375-6-6	SBR	.19	4,8	.63	15,9	.38	9,5
.437	11,1	G1057	RG 437-8-6	SBR	.25	6,4	.63	15,9	.31	8,0
.562	14,3	G1110	RG 562-6-6	Nitrile	.19	4,8	.75	19,1	.31	8,0
		G1115	RG 562-10-6	SBR	.31	8,0	.81	20,7	.38	9,5
		G1116	RG 562-10-6A	SBR	.31	8,0	.81	20,7	.44	11,1
		G1120	RG 562-12-6	SBR	.38	9,5	.81	20,7	.38	9,5
.625	15,9	G1133	RG 625-12-6	SBR	.38	9,5	.88	22,2	.44	11,1
		G1135	RG 625-13-6	Nitrile	.40	10,2	1.10	27,9		
.687	17,5	G1153	RG 687-14-6	SBR	.44	11,1	.94	23,8	.44	11,1
.750	19,1	G1172	RG 750-10-6	SBR	.31	8,0	1.00	25,4		
		G1194	RG 812-16-6	SBR	.50	12,7	1.06	27,0		
.812	20,6	G1199	RG 812-18-6	SBR	.56	14,3	1.06	27,0		
		G1213	RG 875-18-6	SBR	.56	14,3	1.06	27,0		
.875	22,2	G1219	RG 875-20-6	SBR	.63	15,9	1.13	28,6	.50	12,7
		G1256	RG 1000-22-6	SBR	.69	17,5	1.31	33,4		
1.000	25,4	G1261	RG 1000-24-6	SBR	.75	19,1	1.25	31,8	.56	14,3
1.062	27,0	G1272	RG 1062-24-6	SBR	.75	19,1	1.38	34,9	.50	12,7
1.250	31,8	G1306	RG 1250-28-6	SBR	.88	22,2	1.63	41,3	.56	14,3
		G1312	RG 1250-32-6	SBR	1.00	25,4	1.50	38,1	.44	11,1
1.375	34,9	G1323	RG 1375-32-6	SBR	1.00	25,4	1.75	44,5	.56	14,3
		G1329	RG 1375-36-6	SBR	1.13	28,6	1.88	47,6	.50	12,7
1.500	38,1	G1351	RG 1500-40-6	EPDM	1.25	31,8	2.00	50,8	.63	15,9
1.750	44,5	G1372	RG 1750-48-6	SBR	1.50	38,1	2.13	54,0	.56	14,3
2.000	50,8	G1390	RG 2000-52-6	SBR	1.63	41,3	2.25	57,2	.75	19,1
2.200	55,9	G1404	RG 2.200-64-6	SBR	2.00	50,8	2.75	69,9	.56	14,2
2.375	60,3	G1414	RG 2.375-64-6	PVC	2.00	50,8	2.75	69,9		

Standard color black.

Quick
Specs

Material
Temperature Range

SBR, Nitrile, EPDM, or PVC
-40°F (-40°C) to 221°F (105°C)

“Stay Connected” with



Bushings, Grommets, HEYcaps & Plugs

a PennEngineering® Company



Heyco® Thick Panel Rubber Grommets

For Panels .250" (6,4 mm) to .375" (9,5 mm) Thick

MOUNTING HOLE DIAMETER		PART NO.	DESCRIPTION	MATERIAL	PART DIMENSIONS					
in.	mm.				A Inside Diameter		B Head Diameter		C Overall Height	

For .250" (6,4 mm) Thick Panels

.312	7,9	G1023	RG 312-6-8	SBR	.19	4,8	.44	11,1	.38	9,5
.437	11,1	G1058	RG 437-8-8	Nitrile	.25	6,4	.63	15,9		
.500	12,7	G1086	RG 500-10-8	Nitrile	.31	8,0	.63	15,9	.63	15,9
		G1095	RG 500-12-8	SBR	.38	9,5	.75	19,1		
.562	14,3	G1117	RG 562-10-8	Nitrile	.31	8,0	.81	20,6	.50	12,7
.625	15,9	G1134	RG 625-12-8	SBR	.38	9,5	.88	22,2		
.687	17,5	G1154	RG 687-14-8	SBR	.44	11,1	.94	23,8		
.812	20,6	G1195	RG 812-16-8	SBR	.50	12,7	1.06	27,0		
		G1200	RG 812-18-8	SBR	.56	14,3	1.06	27,0		
.875	22,2	G1220	RG 875-20-8	SBR	.63	15,9	1.13	28,6		
1.000	25,4	G1257	RG 1000-22-8	SBR	.69	17,5	1.31	33,3	.56	14,3
		G1264	RG 1000-28-8	SBR	.88	22,2	1.25	31,8		
1.062	27,0	G1273	RG 1062-24-8	SBR	.75	19,1	1.38	34,9	.56	14,3
1.125	28,6	G1279*	RG 1125-26-8	SBR	.80	20,4	1.38	34,9		
1.250	31,8	G1301	RG 1250-24-8	SBR	.75	19,1	1.63	41,3	.44	11,1
		G1307	RG 1250-28-8	SBR	.88	22,2	1.63	41,3		
1.375	34,9	G1324	RG 1375-32-8	SBR	1.00	25,4	1.75	44,5	.63	15,9
		G1353	RG 1500-40-8	SBR	1.25	31,8	1.75	44,5		
1.500	38,1	G1354	RG 1500-40-8A	SBR	1.25	31,8	2.00	50,8	.52	13,1
		G1373	RG 1750-48-8	SBR	1.50	38,1	2.00	50,8		
1.750	44,5	G1374	RG 1750-48-8A	SBR	1.50	38,1	2.13	54,0	.63	15,9
		G1393	RG 2000-56-8	SBR	1.75	44,5	2.50	63,5		
2.000	50,8	G1394	RG 2000-56-8A	Nitrile	1.75	44,5	2.50	63,5	.53	13,5
		G1421	RG 2.5-64-8	SBR	2.00	50,8	3.00	76,2		
2.500	63,5	G1425	RG 2.5-72-8	SBR	2.25	57,2	3.00	76,2	.63	15,9

For .375" (9,5 mm) Thick Panels

.375	9,5	G1043	RG 375-10-12	SBR	.31	8,0	.56	14,3	.50	12,7
.500	12,7	G1096	RG 500-12-12	SBR	.38	9,5	.63	15,9		
.562	14,3	G1121	RG 562-12-12	SBR	.38	9,5	.75	19,1	.63	15,9
.625	15,9	G1136	RG 625-13-12	SBR	.41	10,3	.81	20,6		
.750	19,1	G1182	RG 750-16-12	SBR	.50	12,7	1.00	25,4		
.875	22,2	G1214	RG 875-18-12	SBR	.56	14,3	1.06	27,0		
.968	24,6	G1232	RG 968-22-12	SBR	.69	17,4	1.31	33,3		
1.000	25,4	G1249	RG 1000-18-12	SBR	.56	14,3	1.25	31,8	1.13	28,6
1.125	28,6	G1278	RG 1125-24-12	SBR	.75	19,1	1.63	41,3		
1.250	31,8	G1308	RG 1250-28-12	Neoprene	.88	22,2	1.75	44,5	.75	19,1
		G1314	RG 1250-32-12	SBR	1.00	25,4	1.50	38,1		
1.375	34,9	G1326	RG 1375-32-12	SBR	1.00	25,4	1.75	44,5	.75	19,1
1.750	44,5	G1375	RG 1750-48-12	SBR	1.50	38,1	2.13	54,0		
2.000	50,8	G1395	RG 2000-56-12	SBR	1.75	44,5	2.50	63,5	.63	15,9
2.500	63,5	G1427	RG 2.5-72-12	SBR	2.25	57,2	3.00	76,2		

Standard color black. *G1279 Panel Thickness is .257" (6,5 mm)

- **Used to protect through holes.** Help eliminate sharp edges so your wires are protected and add aesthetic value to your application.
- 40 sizes available that accommodate mounting holes ranging from .312" (7,9 mm) to holes as large as 2.50" (63,5 mm) in diameter and panel thicknesses of .250" (6,4 mm) and .375" (9,5 mm).
- Rubber grommets are constructed of SBR (unless otherwise noted) with an operating temperature range of -40°F (-40°C) to 221°F (105°C).
- SBR grommets have good water resistant characteristics and are suitable for most moderate chemicals and wet or dry organic acids.
- Provide vibration dampening.

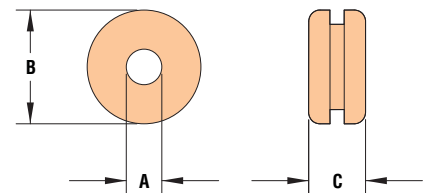

Material: SBR, Nitrile or Neoprene
 Temperature Range: -40°F (-40°C) to 221°F (105°C)

Quick
Specs