



HEYCap™ Tapered Caps and Plugs–NPT

For NPT Fitting Hubs and Threaded Mounting Holes

- HEYCaps can be used as either **caps or plugs**.
- Because they are tapered in design and made from highly flexible polyethylene, they not only **fit snugly** but are readily **removable**.
- Applicable Specs: MIL-C-5501/7 (MIL-C-52078), NAS-835.

CAPS:

- Especially recommended for use on **threaded external NPT fitting hubs**.
- Part dimensions are based on average threaded hub fit. Before ordering in quantity, please sample HEYCaps.
- Recommended Closures: Threaded hubs where Cap dimension B is at least 1% smaller than the hub to be capped. Minimum .020" (0,5 mm).

PLUGS:

- Especially recommended for use on **threaded internal NPT fittings and mounting holes**.
- Part dimensions are based on average tapped hole fit. Before ordering in quantity, please sample HEYCap Tapered Plugs.
- Recommended Closures: Threaded mounting holes where Plug dimension A is at least 1% larger than the hole to be plugged. Minimum .020" (0,5 mm).

Fits this NPT Hub or Mounting Hole	PART NO. Red	DESCRIPTION	PART DIMENSIONS							
			A - Major Body Diameters		B - Minor Body Diameters		C Head Diameter		D Depth	
			in.	mm.	in.	mm.	in.	mm.	in.	mm.

HEYCap Tapered Caps* for NPT Fitting Hubs - Body Diameters reference Inside

1/8	G5014	TCP 49-42†	.42	10,7	.36	9,0	.63	16,0	.38	9,7
1/4	G5020	TCP 61-55	.55	13,8	.47	11,9	.75	19,1	.44	11,2
3/8	G5027	TCP 76-69	.69	17,6	.61	15,6	.88	22,4	.50	12,7
1/2	G5035	TCP 91-85	.85	21,6	.74	18,8	1.06	26,9	.63	16,0
3/4	G5047	TCP 115-108	1.08	27,5	.93	23,7	1.31	33,3	.75	19,1
1	G5057	TCP 136-130	1.30	33,0	1.17	29,8	1.50	38,1	.81	20,6
1-1/4	G5071	TCP 168-162	1.62	41,1	1.50	38,0	1.88	47,8	.75	19,1
1-1/2	G5080	TCP 195-189	1.89	48,0	1.72	43,6	2.13	54,1		
2	G5096	TCP 246-240	2.40	61,0	2.24	56,8	2.63	66,8	1.00	25,4
2-1/2	G5110	TCP 299-295	2.95	74,9	2.69	68,2	3.13	79,5		
3	G5116	TCP 356-349	3.49	88,7	3.20	81,3	3.69	93,7	1.13	28,7

HEYCap Tapered Plugs** for NPT Threaded Mounting Holes - Body Diameters reference Outside

1/8	G5011	TCP 40-33	.40	10,1	.33	8,4	.53	13,5	.38	9,7
1/4	G5014	TCP 49-42†	.49	12,4	.42	10,7	.63	16,0		
3/8	G5022	TCP 63-57	.63	16,0	.55	14,0	.75	19,1	.47	11,9
1/2	G5029	TCP 79-73	.79	20,1	.69	17,5	.94	23,9	.56	14,2
3/4	G5040	TCP 104-98	1.04	26,4	.92	23,4	1.16	29,5	.69	17,5
1	G5048	TCP 122-115	1.22	31,0	1.09	27,7	1.41	35,8	.75	19,1
1-1/4	G5068	TCP 160-154	1.60	40,6	1.51	38,4	1.75	44,5	.50	12,7
1-1/2	G5075	TCP 181-175	1.81	46,0	1.78	45,2	2.00	50,8	.38	9,7
2	G5090	TCP 226-220	2.26	57,4	2.23	56,6	2.50	63,5	.50	12,7
2-1/2	G5106	TCP 279-273	2.79	70,9	2.64	67,1	2.94	74,7		
3	G5115	TCP 346-338	3.46	87,9	3.33	84,6	3.63	92,2	.75	19,1

*May also be used as Plugs: to determine Outside Diameters, add approximately .06" (1,5 mm) to Inside Diameter dimensions.

**May also be used as Caps: to determine Inside Diameters, subtract approximately .06" (1,5 mm) from Outside Diameter dimensions.

†Part No. **G5014** functions as a Cap for NPT 1/8" Hubs and a Plug for NPT 1/4" Hubs. Standard color red.



TAPERED CAP

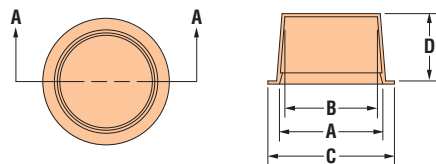

TAPERED PLUG

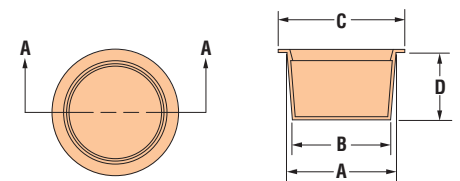

Quick Specs

Material	LDPE
Temperature Range	Standard Color: Red -94°F (-70°C) to 150°F (66°C)



HEYCap™ Tapered Caps and Plugs–SAE

For SAE Fitting Hubs and Threaded Mounting Holes

Fits this SAE Hub or Mounting Hole	PART NO. Red	DESCRIPTION	PART DIMENSIONS							
			A - Major Body Diameters		B - Minor		C		D	
			in.	mm.	in.	mm.	in.	mm.	in.	mm.

HEYCap Tapered Caps* for SAE Fitting Hubs - Body Diameters reference Inside

1/8	G5009	TCP 37-30†	.30	7,7	.24	6,0	.50	12,7		
3/16	G5013	TCP 46-39	.39	10,0	.33	8,3	.59	15,0	.38	9,7
1/4	G5015	TCP 51-45	.45	11,5	.39	9,8	.66	16,8		
5/16	G5022	TCP 63-57	.57	14,4	.49	12,4	.75	19,1	.47	11,9
3/8	G5023	TCP 67-61	.61	15,4	.52	13,2	.81	20,6	.50	12,7
1/2	G5031	TCP 82-76	.76	19,3	.66	16,8	.97	24,6	.57	14,2
5/8	G5036	TCP 93-87	.87	22,0	.75	19,1	1.09	27,7	.63	16,0
3/4	G5047	TCP 115-108	1.08	27,5	.93	23,7	1.31	33,3	.75	19,1
1	G5057	TCP 136-130	1.30	33,0	1.17	29,8	1.50	38,1	.81	20,6
1-1/4	G5071	TCP 168-162	1.62	41,1	1.50	38,0	1.88	47,8	.75	19,1
1-1/2	G5080	TCP 195-189	1.89	48,0	1.72	43,6	2.13	54,1	1.00	25,4
1-3/4	G5092	TCP 231-225	2.25	57,2	2.07	52,7	2.56	65,0		
2	G5097	TCP 260-254	2.54	64,5	2.33	59,3	2.81	71,4	1.03	26,2

HEYCap Tapered Plugs** for SAE Threaded Mounting Holes - Body Diameters reference Outside

1/8	G5007	TCP 30-24	.30	7,7	.24	6,0	.44	11,2		
3/16	G5009	TCP 37-30†	.37	9,3	.30	7,6	.50	12,7	.38	9,7
1/4	G5012	TCP 43-37	.43	10,8	.36	9,2	.56	14,2		
5/16	G5014	TCP 49-42	.49	12,3	.42	10,6	.63	16,0		
3/8††	G5016	TCP 55-49	.55	13,9	.47	12,0	.69	17,5	.44	11,2
	G5020	TCP 61-55	.61	15,4	.53	13,5	.75	19,1		
1/2	G5026	TCP 73-66	.73	18,5	.64	16,3	.88	22,4	.50	12,7
5/8	G5033	TCP 85-79	.85	21,5	.75	19,1	1.00	25,9	.56	9,9
3/4	G5040	TCP 104-98	1.04	26,4	.92	23,2	1.16	29,5	.69	17,5
1	G5049	TCP 128-122	1.28	32,6	1.18	29,8	1.44	36,6	.63	16,0
1-1/4	G5068	TCP 160-154	1.60	40,6	1.51	38,4	1.75	44,5	.50	12,7
1-1/2	G5077	TCP 188-182	1.88	47,8	1.75	44,5	2.00	50,8	.75	19,1
1-3/4	G5089	TCP 224-218	2.24	57,0	2.07	52,5	2.44	62,0	1.00	25,4
2	G5096	TCP 246-240	2.46	62,6	2.30	58,4	2.63	66,8	1.00	25,4

*May also be used as Plugs: to determine Outside Diameters, add approximately .06" (1,5 mm) to Inside Diameter dimensions.

**May also be used as Caps: to determine Inside Diameters, subtract approximately .06" (1,5mm) from Outside Diameter dimensions.

†Part No. G5009 functions as a Cap for SAE 1/8" Hubs and a Plug for SAE 3/16" Hubs.

††Use Part No. G5016 for SAE 9/16-18 thread and Part No. G5020 for SAE 5/8-18 thread Standard color red.

- HEYCaps can be used as either **caps or plugs**.
- Because they are tapered in design and made from highly flexible polyethylene, they not only **fit snugly** but are readily **removable**.
- Applicable Specs: MIL-C-5501/7 (MIL-C-52078), NAS-835.

CAPS:

- Especially recommended for use on **threaded external SAE and MIL Std.-type** tube and hydraulic fittings.
- Part dimensions are based on average threaded hub fit. Before ordering in quantity, please sample HEYCaps.
- Recommended Closures: Threaded hubs where Cap dimension B is at least 1% smaller than the hub to be capped. Minimum .020" (0,5 mm).

PLUGS:

- Especially recommended for use on **threaded internal SAE and MIL Std.-type** tube and hydraulic fittings.
- Part dimensions are based on average tapped hole fit. Before ordering in quantity, please sample HEYCap Tapered Plugs.
- Recommended Closures: Threaded mounting holes where Plug dimension A is at least 1% larger than the hole to be plugged. Minimum .020" (0,5 mm).
- See schematic on page 6-47.



Material	LDPE
Temperature Range	Standard Color: Red -94°F (-70°C) to 150°F (66°C)

Quick
Specs