

Accessories - Cable Clamp Fitting (Low Profile) Fits Metric Threads



Accessories

Part Numbers	Cable Range	Thread Type & Size	Dimensions in Inches (mm)			
			D	B	TL	F
-140°F to 392°F (-60°C to 200°C)			Hole O.D.	Body Length	Thread Length	Wrench Flat
 Nickel Plated Brass	Inches (mm)	See page 56 for thread specs				
KL12MA-BR	.20 - .30 (5 - 7.5)	M12 x 1.5	.47 (12)	.59 (15)	.22 (5.5)	.63 (16)
KL16MA-BR	.28 - .39 (7 - 10)	M16 x 1.5	.63 (16)	.63 (16)	.24 (6)	.75 (19)
KL20MA-BR	.39 - .55 (10 - 14)	M20 x 1.5	.79 (20)	.71 (18)	.26 (6.5)	.94 (24)
KL25MA-BR	.47 - .85 (12 - 21.5)	M25 x 1.5	.98 (25)	.83 (21)	.31 (8)	1.34 (34)
KL32MA-BR	.63 - 1.06 (16-27)	M32 x 1.5	1.26 (32)	.87 (22)	.31 (8)	1.65 (42)
KL40MA-BR	.87 - 1.30 (22-33)	M40 x 1.5	1.57 (40)	1.00 (25.5)	.37 (9.5)	2.05 (52)

RoHS

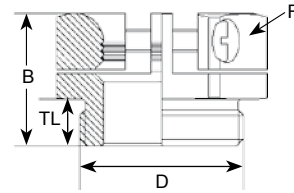

This clamp offers **Extra Pull-out Resistance**. Made of durable Nickel Plated Brass, it offers an excellent solution for your specific application needs. Not a liquid tight solution.

Also available in PG Threads!

Accessories - Deep Socket Wrenches for Strain Relief Fittings

Part Numbers	Used with Sizes		Dimensions in Inches (mm)			
	Nylon Dome Nut	Brass Dome Nut	F	L	d	D
 Socket Wrench	See page 56 for thread specs	See page 56 for thread specs	Wrench Flat	Length	Inner Diameter	Outer Diameter
S-1400-WR	-	PG7, M12	.55 (14)	2.36 (60)	.35 (9)	.75 (19)
S-1500-WR	PG7, M12	-	.59 (15)	2.36 (60)	.37 (9.5)	.79 (20)
S-1700-WR	-	PG 9, 3/8" NPT, M16	.67 (17)	2.36 (60)	.39 (10)	.93 (23.5)
S-1900-WR	PG 9, 3/8" NPT, M16	3/8" NPT, M16	.75 (19)	2.36 (60)	.43 (11)	1.02 (26)
S-2000-WR	-	PG 11, M16-E	.79 (20)	2.36 (60)	.47 (12)	1.06 (27)
S-2200-WR	PG 11, 3/8" NPT, M16-E	PG 13 / 13.5, 1/2" NPT, M20	.87 (22)	2.36 (60)	.51 (13)	1.16 (29.5)
S-2400-WR	PG 13 / 13.5, 1/2" NPT, M20	PG 16, 1/2" NPT-E, M20-E	.94 (24)	2.36 (60)	.59 (15)	1.28 (32.5)
S-2700-WR	PG 16, 1/2" NPT-E, M20-E	-	1.06 (27)	2.36 (60)	.67 (17)	1.40 (35.5)
S-3000-WR	-	PG 21, 3/4" NPT, M25	1.18 (30)	2.36 (60)	.71 (18)	1.59 (40.5)
S-3300-WR	PG 21, 3/4" NPT, M25	-	1.30 (33)	2.36 (60)	.79 (20)	1.71 (43.5)
S-4000-WR	-	PG 29, 1" NPT, M32	1.57 (40)	3.94 (100)	.98 (25)	2.07 (52.5)
S-4100-WR	PG 29	-	1.61 (41)	3.94 (100)	1.06 (27)	2.11 (53.5)
S-4200-WR	PG 29, 1", 1-1/4" NPT, M32	-	1.65 (42)	3.94 (100)	1.06 (27)	2.15 (54.5)
S-4600-WR	1-1/4" NPT	-	1.81 (46)	3.94 (100)	1.22 (31)	2.36 (60)
S-5000-WR	-	PG 36, M40	1.97 (50)	3.94 (100)	1.26 (32)	2.58 (65.5)
S-5300-WR	PG 36, 1-1/2" NPT, M40	-	2.09 (53)	3.94 (100)	1.26 (32)	2.82 (71.5)
S-5500-WR	M 50	M 50	2.17 (55)	3.94 (100)	1.26 (32)	2.83 (72)
S-5700-WR	-	PG 42, M50	2.24 (57)	3.94 (100)	1.42 (36)	2.97 (75.5)
S-6000-WR	PG 42, M50	-	2.36 (60)	3.94 (100)	1.50 (38)	3.09 (78.5)
S-6400-WR	-	PG 48, M63	2.52 (64)	3.94 (100)	1.57 (40)	3.31 (84)
S-6500-WR	PG 48, M63	-	2.56 (65)	3.94 (100)	1.65 (42)	3.35 (85)
S-6800-WR	M63	M63	2.68 (68)	3.94 (100)	1.65 (42)	3.43 (87)

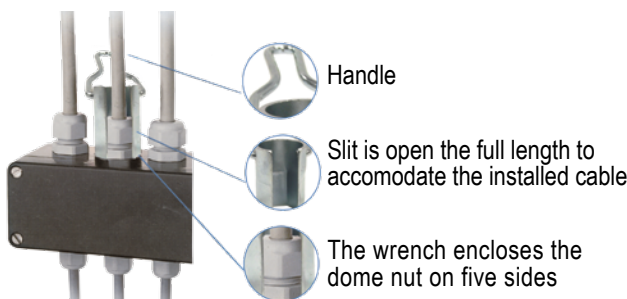

The handy, lightweight **Deep Socket Wrench** is manufactured from alloy steel. It is slit open along the full length to accommodate the installed cable during tightening of the dome nut. The wrench encloses the dome nut on five sides, giving the nut additional rigidity during tightening. This is especially important if a stiff cable is used. Does not work with all Flex Fittings.

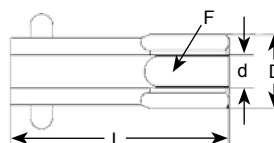

For Material Specifications and Approval Information refer to page 52.

NPT Threads

Thread Size	1/4" NPT	3/8" NPT	1/2" NPT	3/4" NPT	1" NPT	1-1/4" NPT	1-1/2" NPT	2" NPT
Major Dia. in Inches (mm)	.54 (13.72)	.675 (17.145)	.84 (21.336)	1.05 (26.67)	1.314 (33.40)	1.66 (42.164)	1.90 (48.26)	2.375 (60.325)
Pitch in Inches (mm)	.056 (1.41)	.056 (1.411)	.071 (1.814)	.071 (1.814)	.087 (2.208)	.087 (2.208)	.087 (2.208)	.087 (2.208)
Threads per Inch	18	18	14	14	11.5	11.5	11.5	11.5

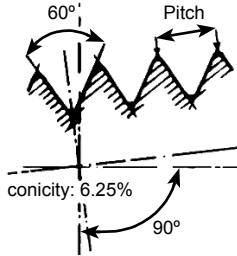

- NPT Thread = National Pipe Thread
- Taper rate for all NPT threads is 1/16
- The taper on NPT threads allows them to form a seal when torqued as the flanks of the threads compress against each other, as opposed to straight thread fittings

Metric Threads

Thread Size	M6	M8	M10	M12	M16	M20	M25	M32	M40	M50	M63
Major Dia. in Inches (mm)	.24 (6)	.31 (8)	.39 (10)	.47 (12)	.63 (16)	.79 (20)	.98 (25)	1.26 (32)	1.57 (40)	1.97 (50)	2.48 (63)
Pitch in Inches (mm)	.04 (1)	.05 (1.25)	.06 (1.5)	.059 (1.5)	.059 (1.5)	.059 (1.5)	.059 (1.5)	.059 (1.5)	.059 (1.5)	.059 (1.5)	.059 (1.5)
Thru Hole in Inches (mm)	.251 (6.4)	.33 (8.4)	.413 (10.5)	.492 (12.5)	.63 (16)	.79 (20)	.98 (25)	1.26 (32)	1.57 (40)	1.97 (50)	2.48 (63)

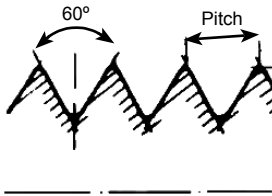

- World-wide most commonly used type thread
- Characterized by its major diameter and its pitch
- Designated by the letter M followed by the value of the nominal diameter and the pitch, both expressed in millimeters and separated by the multiplication sign 'x' (i.e. M12 x 1.5)

PG Threads

Thread Size	PG 7	PG 9	PG 11	PG 13 / 13.5	PG 16	PG 21	PG 29	PG 36	PG 42	PG 48
Major Dia. in Inches (mm)	.49 (12.5)	.60 (15.2)	.73 (18.6)	.80 (20.4)	.89 (22.5)	1.11 (28.3)	1.46 (37)	1.85 (47)	2.13 (54)	2.39 (59.3)
Pitch in Inches (mm)	.05 (1.27)	.056 (1.41)	.056 (1.41)	.056 (1.41)	.056 (1.41)	.062 (1.59)	.062 (1.59)	.062 (1.59)	.062 (1.59)	.062 (1.59)
Thru Hole in Inches (mm)	.50 (12.7)	.606 (15.4)	.74 (18.8)	.8149 (20.7)	.897 (22.8)	1.12 (28.6)	1.47 (37.4)	1.87 (47.5)	2.14 (54.5)	2.35 (59.8)

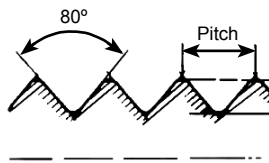

- PG Thread = Panzer-Gewinde (also Panzer-Rohr-Gewinde)
- German thread type
- Depth of thread smaller than NPT or Metric, but larger flank angle
- Straight thread

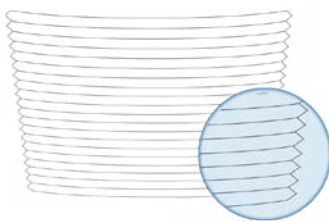

NPT Threads
(Tapered)

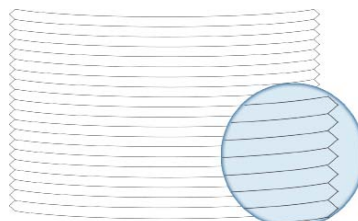

Metric Threads
(Straight)

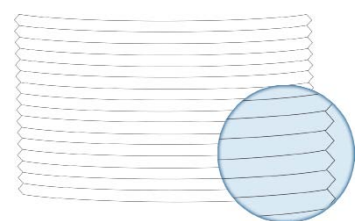

PG Threads
(Straight)