

Terminal Bushings

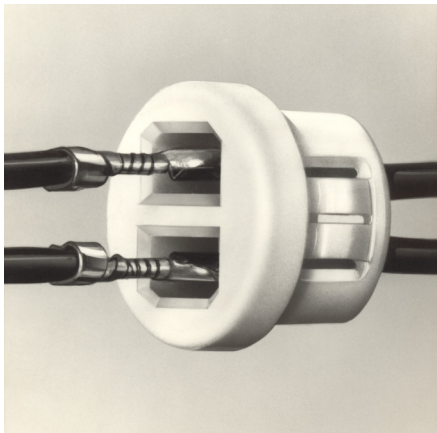

- ◆ Small nylon receptacles for low cost, insulated quick connection or disconnection of your wires thru panels or housings.
- ◆ Typical uses are data processing and vending machines, motors, power supplies and controls.
- ◆ Internal brass male terminals are available in 2 sizes to mate with either 3/16" or 1/4" standard female Quick-Connectors. Both sizes are available in solder, double-male, and crimp configurations.
- ◆ Available in eight colors for color-coding.



DC-251-1
DC-251

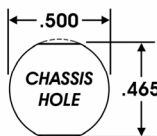
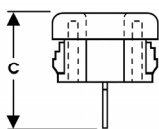

Prevents
Bushings
Rotation



DC-68-1-2

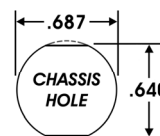
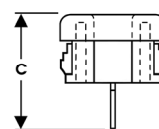

Prevents
Bushings
Rotation

PART NO. and (COLOR)	DESCRIPTION	C OVERALL LENGTH
Red-R Blue-BU Green-G Yellow-Y Orange-O Brown-BR		
4200 (BLACK) 4201 (WHITE) 4202 (R) 4203 (BU) 4204 (G) 4205 (Y) 4206 (O) 4207 (BR)	DC-251-1 WITH T-101-D (3/16") TERMINAL	25/32"
4210 (BLACK) 4211 (WHITE) 4212 (R) 4213 (BU) 4214 (G) 4215 (Y) 4216 (O) 4217 (BR)	DC-251-1 WITH T-101-D (3/16") TINNED TERMINAL	
4220 (BLACK) 4221 (WHITE) 4222 (R) 4223 (BU) 4224 (G) 4225 (Y) 4226 (O) 4227 (BR)	DC-251-1 WITH T-101-S (3/16") TERMINAL	23/32"
4240 (BLACK) 4241 (WHITE) 4242 (R) 4243 (BU) 4244 (G) 4245 (Y) 4246 (O) 4247 (BR)	DC-251 WITH T-202-D (1/4") TERMINAL	7/8"
4250 (BLACK) 4251 (WHITE) 4252 (R) 4253 (BU) 4254 (G) 4255 (Y) 4256 (O) 4257 (BR)	DC-251 WITH T-202-D (1/4") TINNED TERMINAL	
4260 (BLACK) 4261 (WHITE) 4262 (R) 4263 (BU) 4264 (G) 4265 (Y) 4266 (O) 4267 (BR)	DC-251 WITH T-202-S (1/4") TERMINAL	55/64"
4270 (BLACK) 4271 (WHITE) 4272 (R) 4273 (BU) 4274 (G) 4275 (Y) 4276 (O) 4277 (BR)	DC-251 WITH T-202-S (1/4") TINNED TERMINAL	
4280 (BLACK) 4281 (WHITE) 4282 (R) 4283 (BU) 4284 (G) 4285 (Y) 4286 (O) 4287 (BR)	DC-251 WITH T-202-SS (1/4") TERMINAL	11/16"
4290 (BLACK) 4291 (WHITE) 4292 (R) 4293 (BU) 4294 (G) 4295 (Y) 4296 (O) 4297 (BR)	DC-251 WITH T-202-SS (1/4") TINNED TERMINAL	

PART NO. and (COLOR)	DESCRIPTION	C OVERALL LENGTH
Red-R Blue-BU Green-G Yellow-Y Orange-O Brown-BR		
4380 (BLACK) 4381 (WHITE) 4382 (R) 4383 (BU) 4384 (G) 4385 (Y) 4386 (O) 4387 (BR)	DC-68-1-2 WITH T-202-D (1/4") TERMINAL	57/64"
4390 (BLACK) 4391 (WHITE) 4392 (R) 4393 (BU) 4394 (G) 4395 (Y) 4396 (O) 4397 (BR)	DC-68-1-2 WITH T-202-D (1/4") TINNED TERMINAL	
4400 (BLACK) 4401 (WHITE) 4402 (R) 4403 (BU) 4404 (G) 4405 (Y) 4406 (O) 4407 (BR)	DC-68-1-2 WITH T-202-S (1/4") TERMINAL	7/8"
4410 (BLACK) 4411 (WHITE) 4412 (R) 4413 (BU) 4414 (G) 4415 (Y) 4416 (O) 4417 (BR)	DC-68-1-2 WITH T-202-S (1/4") TINNED TERMINAL	
4420 (BLACK) 4421 (WHITE) 4422 (R) 4423 (BU) 4424 (G) 4425 (Y) 4426 (O) 4427 (BR)	DC-68-1-2 WITH T-202-SS (1/4") TERMINAL	45/64"
4430 (BLACK) 4431 (WHITE) 4432 (R) 4433 (BU) 4434 (G) 4435 (Y) 4436 (O) 4437 (BR)	DC-68-1-2 WITH T-202-SS (1/4") TINNED TERMINAL	



P.O. Box 678 Waukesha, Wisconsin 53187

(262) 820-1060 (800) 558-4388

Fax (262)-820-1070

sales@cablecomponentsinc.com

Terminal Bushings

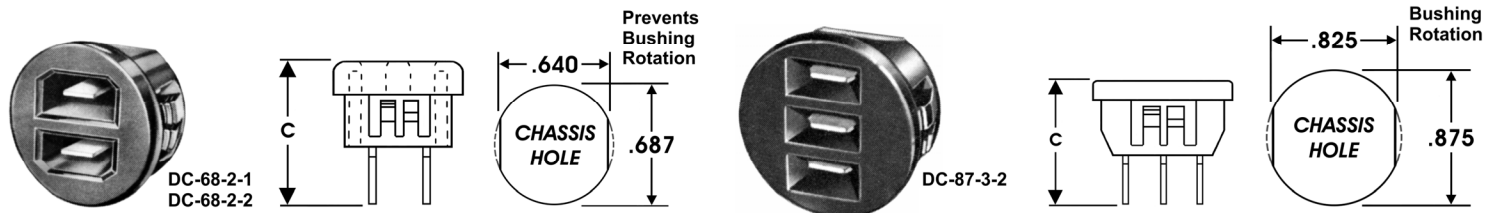

PART NO. and (COLOR) Red-R Blue-BU Green-G Yellow-Y Orange-O Brown-BR	DESCRIPTION	C OVERALL LENGTH
4340 (BLACK) 4341 (WHITE) 4342 (R) 4343 (BU) 4344 (G) 4345 (Y) 4346 (O) 4347 (BR)	DC-68-2-1 WITH TWO T-101-D (3/16") TERMINALS	13/16"
4350 (BLACK) 4351 (WHITE) 4352 (R) 4353 (BU) 4354 (G) 4355 (Y) 4356 (O) 4357 (BR)	DC-68-2-1 WITH TWO T-101-D TINNED (3/16") TERMINALS	
4360 (BLACK) 4361 (WHITE) 4362 (R) 4363 (BU) 4364 (G) 4365 (Y) 4366 (O) 4367 (BR)	DC-68-2-1 WITH TWO T-101-S (3/16") TERMINALS	47/64"
4440 (BLACK) 4441 (WHITE) 4442 (R) 4443 (BU) 4444 (G) 4445 (Y) 4446 (O) 4447 (BR)	DC-68-2-2 WITH TWO T-202-D (1/4") TERMINALS	57/64"
4450 (BLACK) 4451 (WHITE) 4452 (R) 4453 (BU) 4454 (G) 4455 (Y) 4456 (O) 4457 (BR)	DC-68-2-2 WITH TWO T-202-D TINNED (1/4") TERMINALS	
4460 (BLACK) 4461 (WHITE) 4462 (R) 4463 (BU) 4464 (G) 4465 (Y) 4466 (O) 4467 (BR)	DC-68-2-2 WITH TWO T-202-S (1/4") TERMINALS	7/8"
4470 (BLACK) 4471 (WHITE) 4472 (R) 4473 (BU) 4474 (G) 4475 (Y) 4476 (O) 4477 (BR)	DC-68-2-2 WITH TWO T-202-S TINNED (1/4") TERMINALS	
4480 (BLACK) 4481 (WHITE) 4482 (R) 4483 (BU) 4484 (G) 4485 (Y) 4486 (O) 4487 (BR)	DC-68-2-2 WITH TWO T-202-SS (1/4") TERMINALS	45/64"
4490 (BLACK) 4491 (WHITE) 4492 (R) 4493 (BU) 4494 (G) 4495 (Y) 4496 (O) 4497 (BR)	DC-68-2-2 WITH TWO T-202-SS TINNED (1/4") TERMINALS	

PART NO. and (COLOR)	DESCRIPTION	C OVERALL LENGTH
4520 (BLACK) 4521 (WHITE) 4522 (RED)	DC-87-3-2 WITH THREE T-202-D (1/4") TERMINALS	7/8"
4525 (BLACK) 4526 (WHITE) 4527 (RED)	DC-87-3-2 WITH THREE T-202-D TINNED (1/4") TERMINALS	
4530 (BLACK) 4531 (WHITE) 4532 (RED)	DC-87-3-2 WITH THREE T-202-S (1/4") TERMINALS	55/64"
4535 (BLACK) 4536 (WHITE) 4537 (RED)	DC-87-3-2 WITH THREE T-202-S TINNED (1/4") TERMINALS	
4540 (BLACK) 4541 (WHITE) 4542 (RED)	DC-87-3-2 WITH THREE T-202-SS (1/4") TERMINALS	11/16"
4545 (BLACK) 4546 (WHITE) 4547 (RED)	DC-87-3-2 WITH THREE T-202-SS TINNED (1/4") TERMINALS	



P.O. Box 678 Waukesha, Wisconsin 53187

(262) 820-1060 (800) 558-4388

Fax (262)-820-1070

sales@cablecomponentsinc.com

Unassembled Terminal Bushings

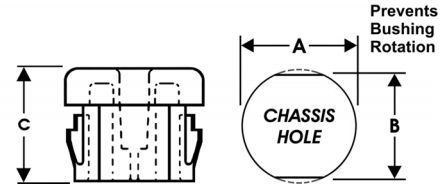
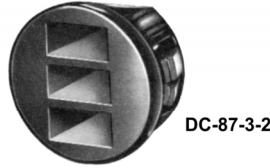
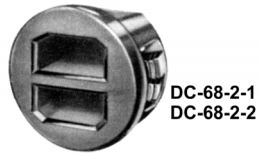

Plastic Seals Ltd. Bushings

PART NO. and COLOR [†]	Description	Terminal Accommodated		CHASSIS DIMENSIONS			C Bushing Length
		Width	Qty.	A	B Prevents Bushing Rotation	Maximum Chassis Thickness	
4032 (Black) 4031 (White)	DC-251-1	3/16"	1	.500"	.465"	.125"	1/2"
4022 (Black) 4021 (White)	DC-251	1/4"					
4042 (Black) 4041 (White)	DC-68-1-2	1/4"	2	.687"	.640"	.125"	17/32"
4060 (Black) 4059 (White)	DC-68-2-1	3/16"					
4062 (Black) 4061 (White)	DC-68-2-2	1/4"					
4082 (Black) 4081 (White)	DC-87-3-2	1/4"	3	.875"	.825"	.125"	1/2"

†Standard Color: Black or White. (Red, Orange, Yellow, Green, Blue and Brown also available at extra charge.)

Heyco Brass Terminals [Tin plated terminals available (not shown); minimum quantities may apply]

Terminal Configuration	Part No.	Description	Dimensions		
			A Overall Length	B	C Terminal Width
 SOLDER	4700	T-101-S	.61"	.41"	3/16"
	4800	T-202-S	.81"	.47"	1/4"
	4810	T-202-SS	.65"		
 DOUBLE MALE	4720	T-101-D	.69"	.41"	3/16"
	4830	T-202-D	.83"	.47"	1/4"
 CRIMP	4820	T-202-C	.81"	.47"	1/4"

Cable Components, Inc.

P.O. Box 678 Waukesha, Wisconsin 53187

(262) 820-1060 (800) 558-4388

Fax (262)-820-1070

sales@cablecomponentsinc.com